

PROPOSED DRAINAGE DETAILS

NETWORK	PROPOSED AREA (ha)	PROPOSED AREA (SEE NOTE 1)	OUTFALL LOCATION
A	2.98	0	OX HEZ BROOK
A2	0	0.4	OX HEZ BROOK
B	6.44	6.44	LADY BROOK
B3	0	0.91	LADY BROOK
C	4.27	3.40	POTTON BROOK
C2	0	0.54	EXISTING WATERCOURSE
C3	0	0.23	EXISTING WATERCOURSE
C4	0	0.07	POTTON BROOK
D	3.76	3.35	EXISTING A655 DRAINAGE
E	4.77	7.06	EXISTING A655 DRAINAGE
F	2.72	0.19	PROPOSED RINGWAY ROAD DRAINAGE
L	5.18	2.42	SPAVI BROOK
M	1.22	0	GATLEY BROOK

- NOTES:**
- TOTAL AREA FOR EACH NETWORK TRASS INTO ACCOUNT FIGURE OF 63 HAS BEEN USED BASED ON TABLE 3.2008 FROM BS EN 752:2008.
 - REFER TO DRAINAGE STRATEGY REPORT AND SUPPORTING APPENDICES FOR DETAILS OF EACH OF THE ABOVE NETWORKS AND THE DRAINAGE STRATEGY REPORT 10076/10078/10082.
 - ABOVE TABLE SURVEYED CALCULATION OF DRAINAGE STRATEGY REPORT 10076/10078/10082.

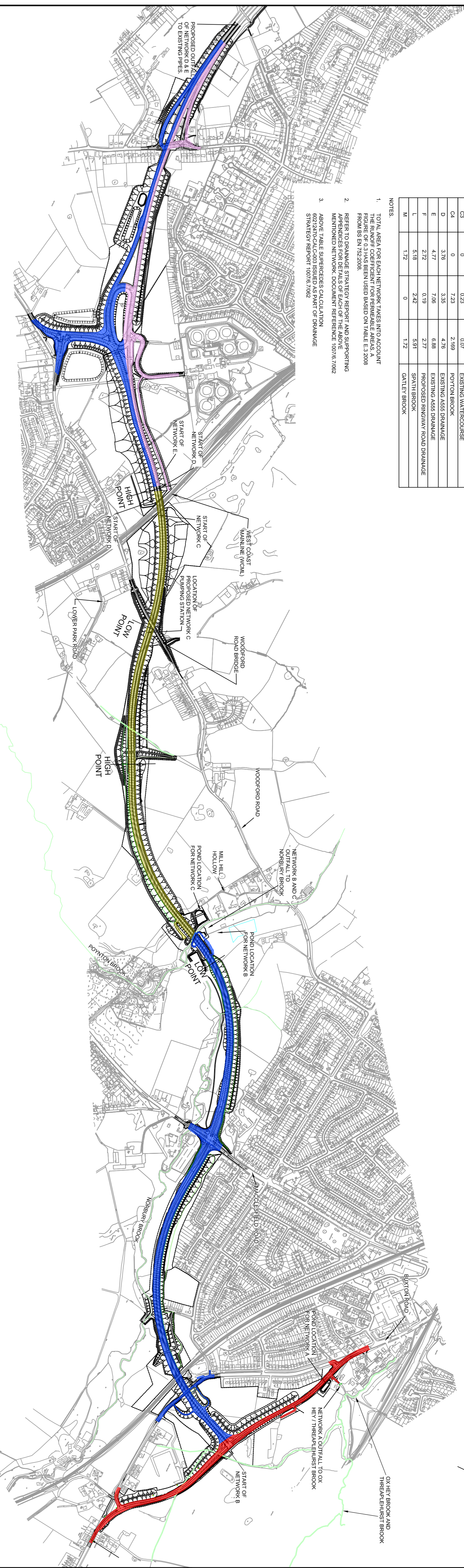

HATCHING INDICATES FOOTPRINT OF PROPOSED HIGHWAY DESIGN. REFERENCE: TEST RUN 1.

HATCHING INDICATES FOOTPRINT OF PROPOSED HIGHWAY DESIGN. REFERENCE: TEST RUN 1.

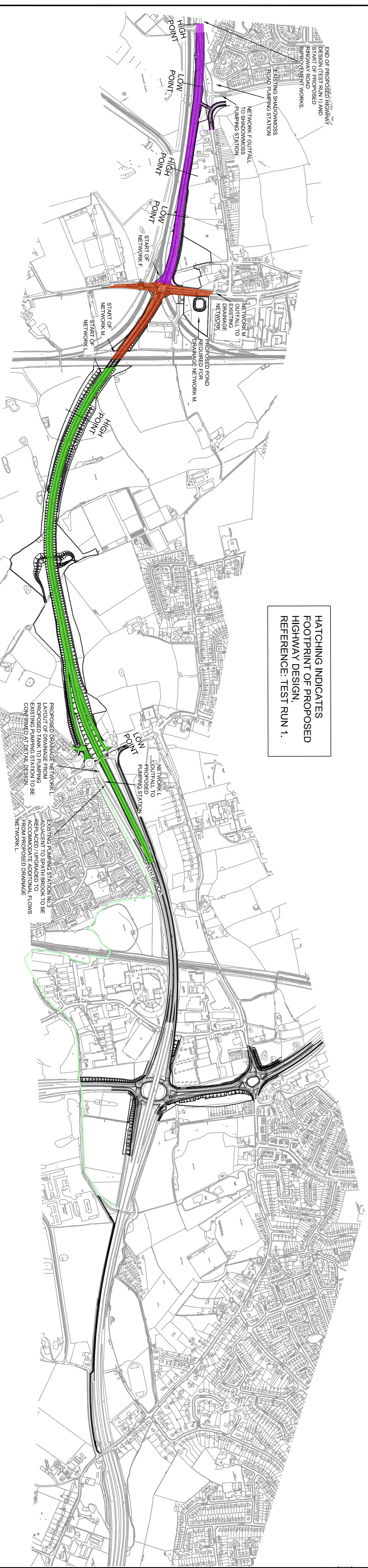

Client: STOCKPORT METROPOLITAN BOROUGH COUNCIL

Project: SEMMMS A6 RELIEF ROAD

Title: SUMMARY OF PROPOSED DRAINAGE NETWORKS SHEET 1

Design:	FB	CAD:	EC
CHK:	FB	Appr:	MCH
Date:	14/06/2013	Scale:	NTS

AECOM
 11th Floor, Church Street
 ALTRINCHAM, WA14 4DZ
 Tel: +44 (0) 1827 8200
 Fax: +44 (0) 1827 8200
 www.aecom.com

No. 60212470-HIG-0535

Rev: P03

Sheet: A1

NOTES:

- THIS DRAWING IS TO BE READ IN CONJUNCTION WITH ALL OTHER RELEVANT DRAWINGS. ANY DISCREPANCIES, ERRORS OR OMISSIONS TO BE BROUGHT TO THE ATTENTION OF THE OVERSEEING ORGANISATION.
- LATEST HIGHWAY LAYOUT AND LEVEL INFORMATION RECEIVED FROM STOCKPORT METROPOLITAN BOROUGH COUNCIL IN APRIL 2011.
- REFER TO DRAWING 60212470-HIG-0501 TO 60212470-HIG-0517 FOR FURTHER DETAILS OF PROPOSED DRAINAGE NETWORKS

Rev: P03

CAD File : F:\projects\Highways - SEMMMS A6 Relief Road\01 Autocad\01 Output\60212470-HIG-0535.dwg ; Plotted on 10/4/2013 12:03 PM by Bainbridge, Paul